



IndigoVision

BXRANGE

30x
Optical



4MP PTZ Dome Camera

High-end: performance, not price tag.

With BX 4MP PTZ Dome Cameras you get supreme connectivity and flexibility, combined with great video and audio. You also get maximum reliability, and the other significant benefits of IndigoVision's Distributed Network Architecture. BX 4MP PTZ Dome Cameras deliver a different dimension of safety when combined with IndigoVision's Control Center.

Key Features

SENSOR

- 4MP
- Day/Night
- WDR

COMPRESSION

- H.264
- UP TO 60fps
- G.711

INTELLIGENCE

- Analytics
- Motion Detection

OTHER

- PoE+
- DNA
- ONVIF

PHYSICAL

- Outdoor
- IK10
- Low Temp
- In-Ceiling

Product Codes

BX520 4MP PTZ Dome Camera	Camera
In-Ceiling 4MP PTZ Dome	611500
Environmental Pendant 4MP PTZ Dome	611560

Product Code 66xxxx also available to order consisting of 61xxxx Product Code plus Enhanced Management Software License.

Dimensions - In-Ceiling PTZ Dome

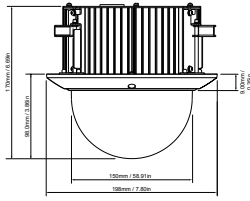

View on Side Face

Dimensions - Environmental Pendant PTZ Dome

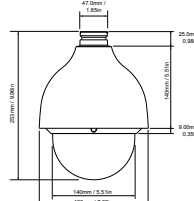

View on Side Face

Dimensions - Wall Mount

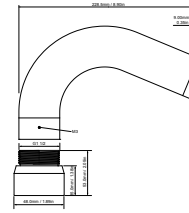

View on Side Face

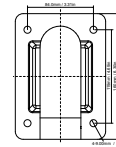

View on Front Face

Specification

Camera Features	
Sensor	1/2.8" Progressive CMOS
Active Pixels (HxV)	4MP (2560 x 1440)
Horizontal Resolution	> 900 TVL
Minimum Sensitivity	Day: 0.05 Lux (colour). Night: 0.01 Lux (mono). 30 IRE, F1.6, 1/10s shutter
Dynamic Range	WDR 100dB Max
Gain Control	Auto/Manual setting
Back Light Compensation	On/Off
White Balance Mode	Auto/Manual
Day/Night	True Day/Night with Mechanical IR Cut Filter
Video Resolution	2560 x 1440 pixels (4MP); 1920x1080 pixels (1080p); 1280x720 pixels (720p); 720x576 pixels (D1); 352x288 pixels (SIF)
Signal/Noise Level	> 50dB
Lens Options	4.3mm - 129mm Horizontal view angle 66.5°(W) 3.25° (T), F1.6 to F4.4, Auto focus with manual override
Zoom	30x optical + 10x digital
Iris Control	Auto with manual override
Shutter	Rolling; Auto from 1 - 1/10000 sec
Exposure Control	Auto/Manual/Slow AE/Shutter-priority/Iris-priority
Video Compression	Full frame rate, full colour: H.264/MJPEG ; up to 60fps (ISO 14496-10)
Video Bit Rate	User-configurable bit rates from 64Kbps up to 8Mbps
Video Multi-Streaming	Up to 32Mbps total video output; Unlimited multicast connections. Up to four 8Mbps unicast connections
Video Multi-Encoder	Up to three simultaneous resolutions including: 4MP (30fps), 1080p (60fps), 720p (30fps), D1 (30fps), SIF (30fps)
Video Analytics	Motion Detection, Hooded, Tripwire, Intrusion
Audio Compression	G.711
Audio Bit Rate	32Kbps per channel
Audio Resolution	Full Duplex 8kHz sample rate. Mono Input, Mono Output
Audio Input	Line in
Audio Output	Line out
Binary Input/Output	2 Pull up inputs for non powered contacts; 1 solid state opto-isolated relay output, Max 24V, 500mA
Network Interface	IEEE802.3 and IETF standards: 10/100 Base-T Ethernet, TCP, UDP, RTP, RTSP, ICMP, IGMP, SNMP, HTTP, HTTPS, PPPoE, uPnP, QoS, DHCP
Network Security	HTTPS / IP Filter / IEEE 802.1x
Time	Embedded real-time clock, NTP client
SD Storage	microSDHC 128GB support (card not included)*
Regulatory	EN 55022 Class A, EN 61000-3-2, EN 61000-3-3, AS/NZS CISPR 22, FCC Part 15 Subpart B Class A, EN 50130-4, UL 60950-1, UL 60950-22, AS/NZS CISPR 24, IEC 61000-4-2, IEC 61000-4-3, IEC 61000-4-4, IEC 61000-4-5, IEC 61000-4-6, IEC 61000-4-8, IEC 61000-4-11
IndigoVision Software Requirements	Control Center v13.2 or later
ONVIF	Profile S

PTZ Control			
Preset	300	Pan Range	360° Continuous Rotation
Preset Tours	8	Tilt Range	180°
Pattern/Mimic Tours	5	Pan/Tilt Speed	Pan Speed - 0.5-350°/s. Tilt Speed - 0.5-250°/s
Privacy Zones	24 User Defined		

Camera Features	In-Ceiling	Environmental Pendant
Dimensions/Weight	198mm (dia) x 170mm (h) and 2.2Kg / 7.80in (dia) x 6.69in (h) and 4.850lb	186mm (dia) x 253mm (h) and 2.5Kg / 7.32in (dia) x 9.25in (h) and 5.512lb
Housing	Vandal resistant aluminium alloy and Polycarbonate/ABS housing and clear polycarbonate dome including 400mm cable bundle	Vandal resistant aluminium alloy housing and clear polycarbonate dome including 500mm cable bundle
Protection Rating	IK10 (IEC62262)	IP66/IK10 (IEC 62262)
Electrical	PoE + (802.3at Class 4) or 24V AC, 13W. Power supply ordered separately (Product code: 130176)	Camera Only: PoE + (802.3at Class 4) or 24V AC, 13W. Power supply ordered separately (Product code: 130176) Camera with Heater: PoE + (802.3at Class 4) or 24V AC, 23W. Power supply ordered separately (Product code: 130176)
Operating Temperature	-10°C to 60°C (14°F to 140°F)	-20°C to 60°C (-4°F to 140°F) (PoE+ Power); -40°C to 60°C (-40°F to 140°F) (24V AC Power)
Cold Start	-10°C (14°F)	-20°C (-4°F)
Supplied Accessories	N/A	Wall Mount bracket

* SD Card Storage independent of IndigoVision's NVRs.